

PART# SYSTEM - SINGLE DOOR ENCLOSURES

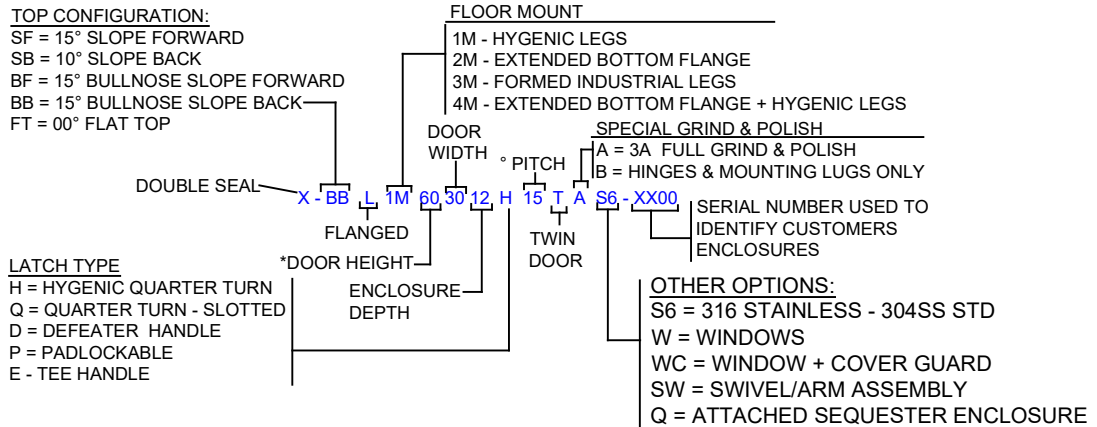

** BACK PANEL PART # SYSTEM

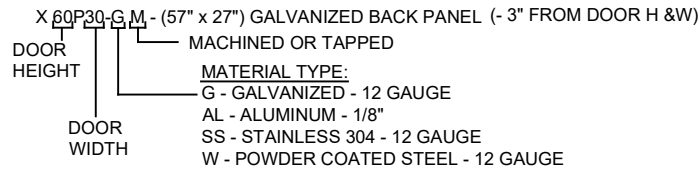

NOTE: * ACTUAL DOOR HEIGHT IS 1/2" TALLER THAN PART# SIZE
 ** BACK PANEL PART NUMBER IS BASED UPON DOOR SIZE

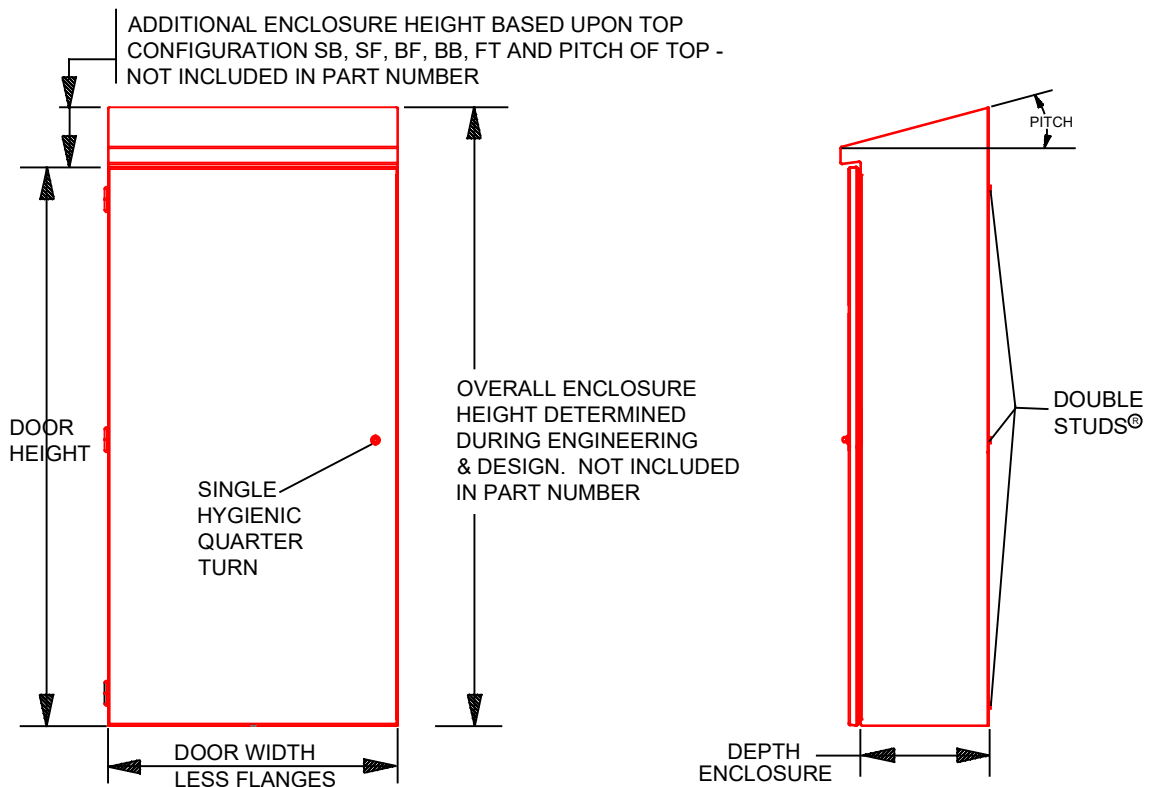

FRONT VIEW

SIDE VIEW

PART# SYSTEM - MULTI DOOR ENCLOSURES

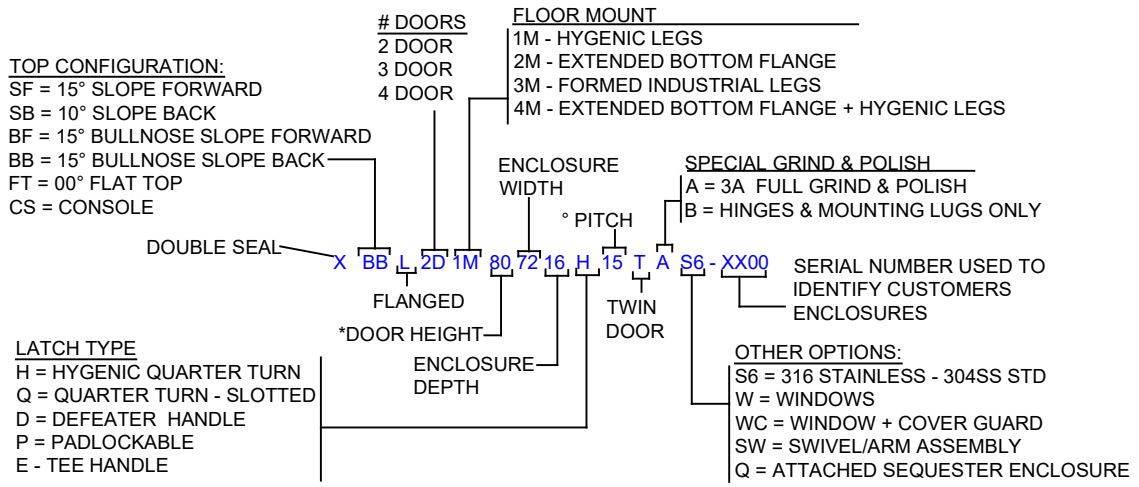

MULTI DOOR - BACK PANEL PART # SYSTEM

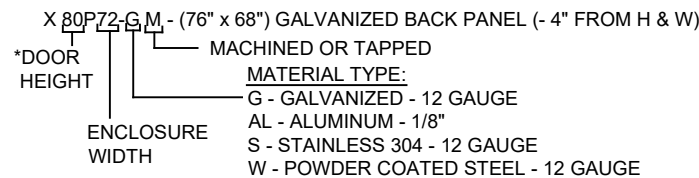

NOTE: * BACK PANEL PART NUMBER IS TYPICALLY BASED UPON ENCLOSURE SIZE

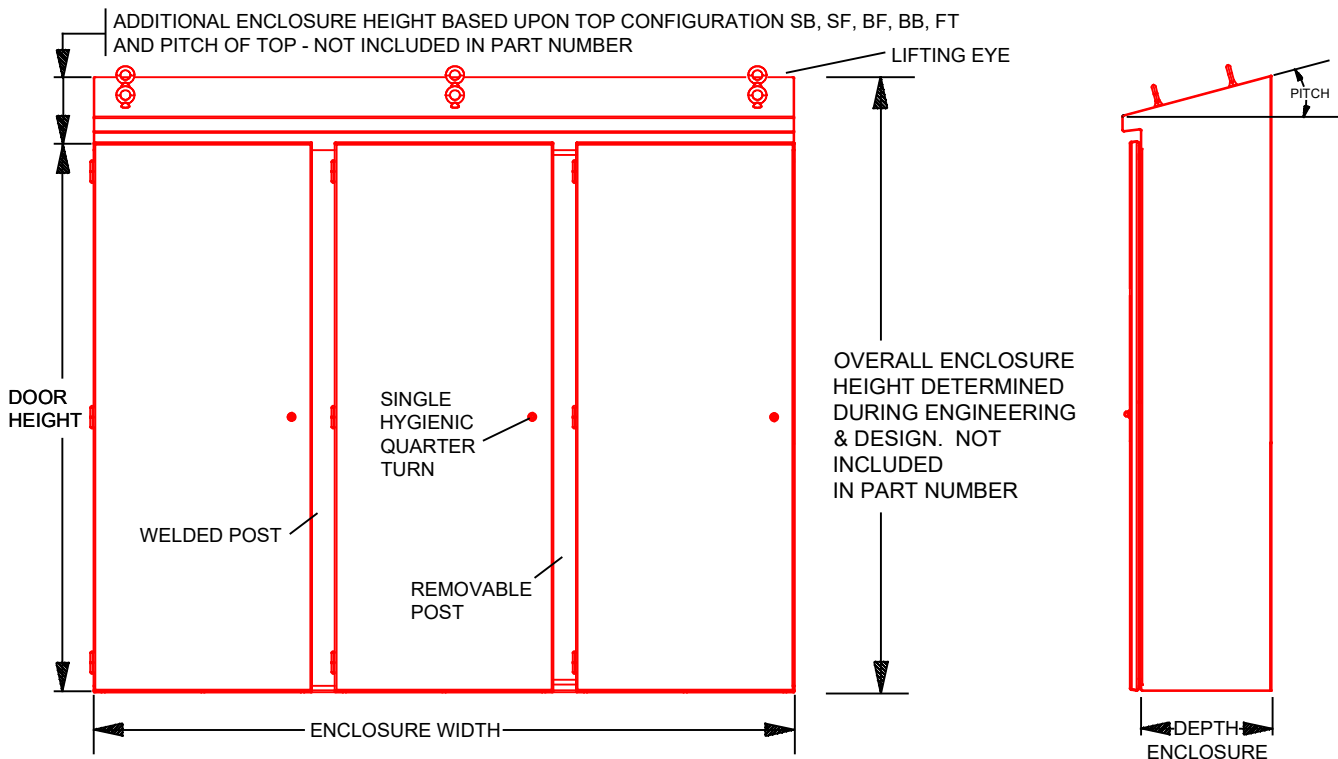

FRONT VIEW

SIDE VIEW

PART# SYSTEM - SINGLE DOOR FLANGED ENCLOSURES

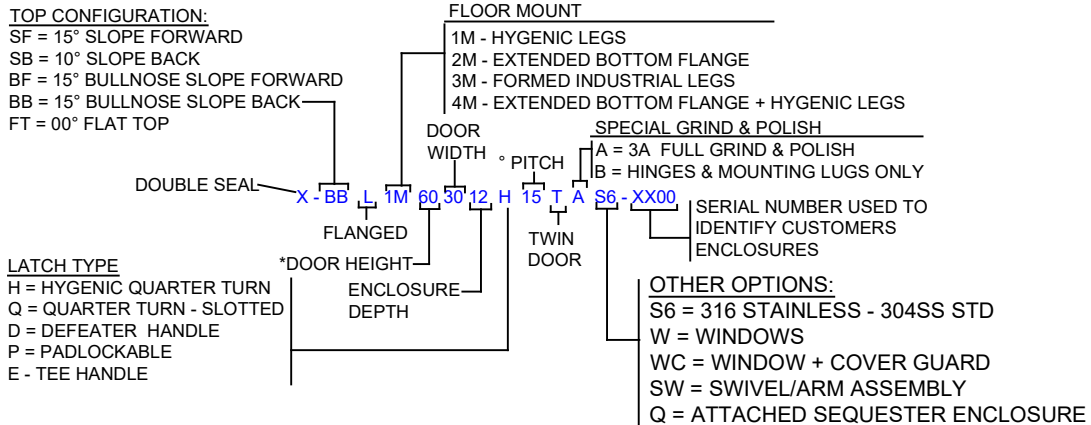

** BACK PANEL PART # SYSTEM

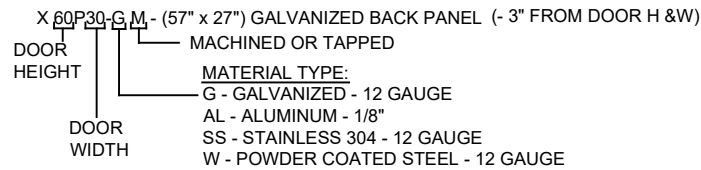

NOTE: * ACTUAL DOOR HEIGHT IS 1/2" TALLER THAN PART# SIZE
 ** BACK PANEL PART NUMBER IS BASED UPON DOOR SIZE

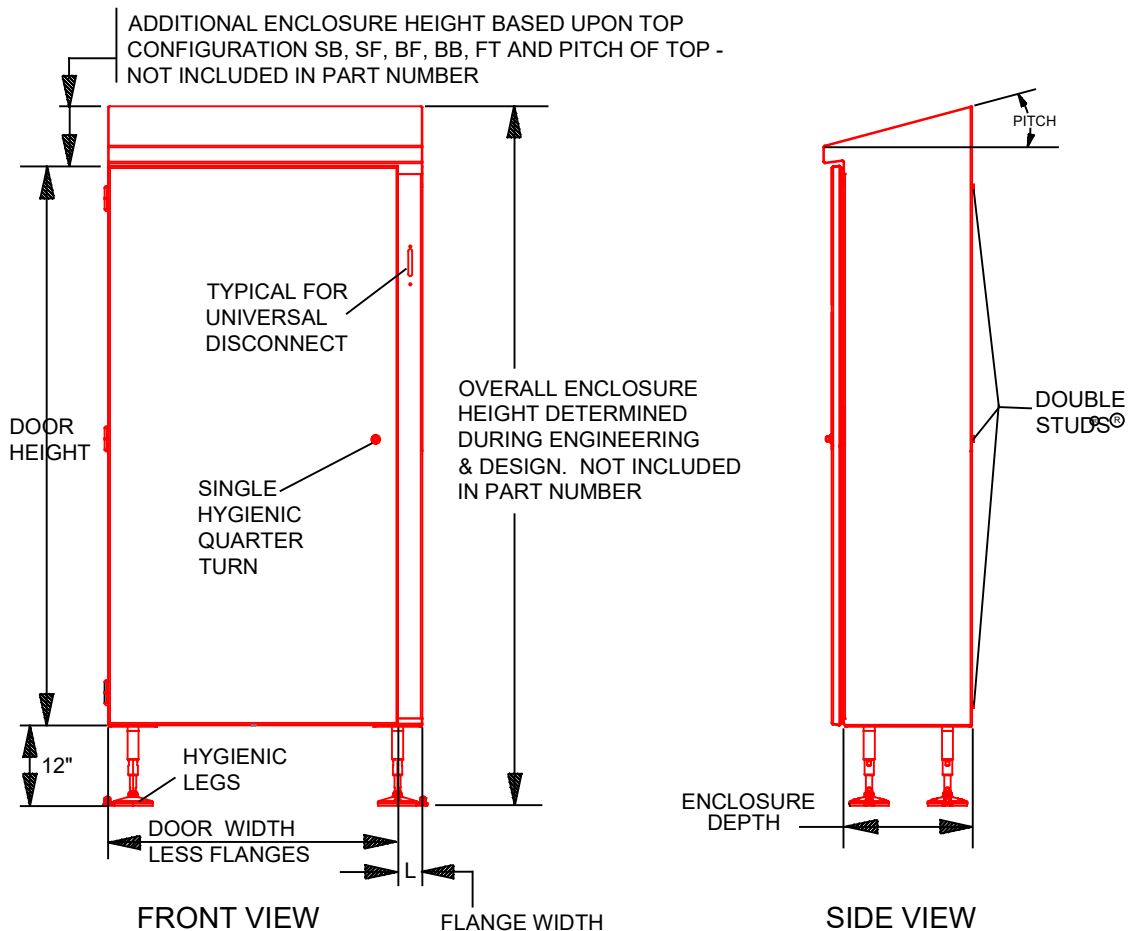

PART# SYSTEM - MULTI DOOR FLANGED ENCLOSURES

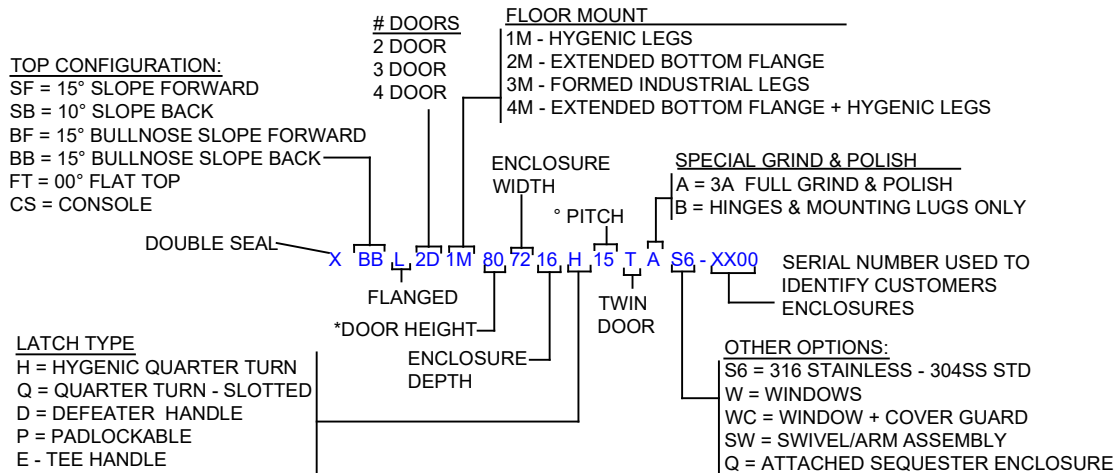

MULTI DOOR - BACK PANEL PART # SYSTEM

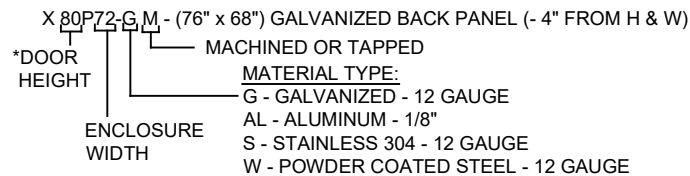

NOTE: * BACK PANEL PART NUMBER IS TYPICALLY BASED UPON ENCLOSURE SIZE

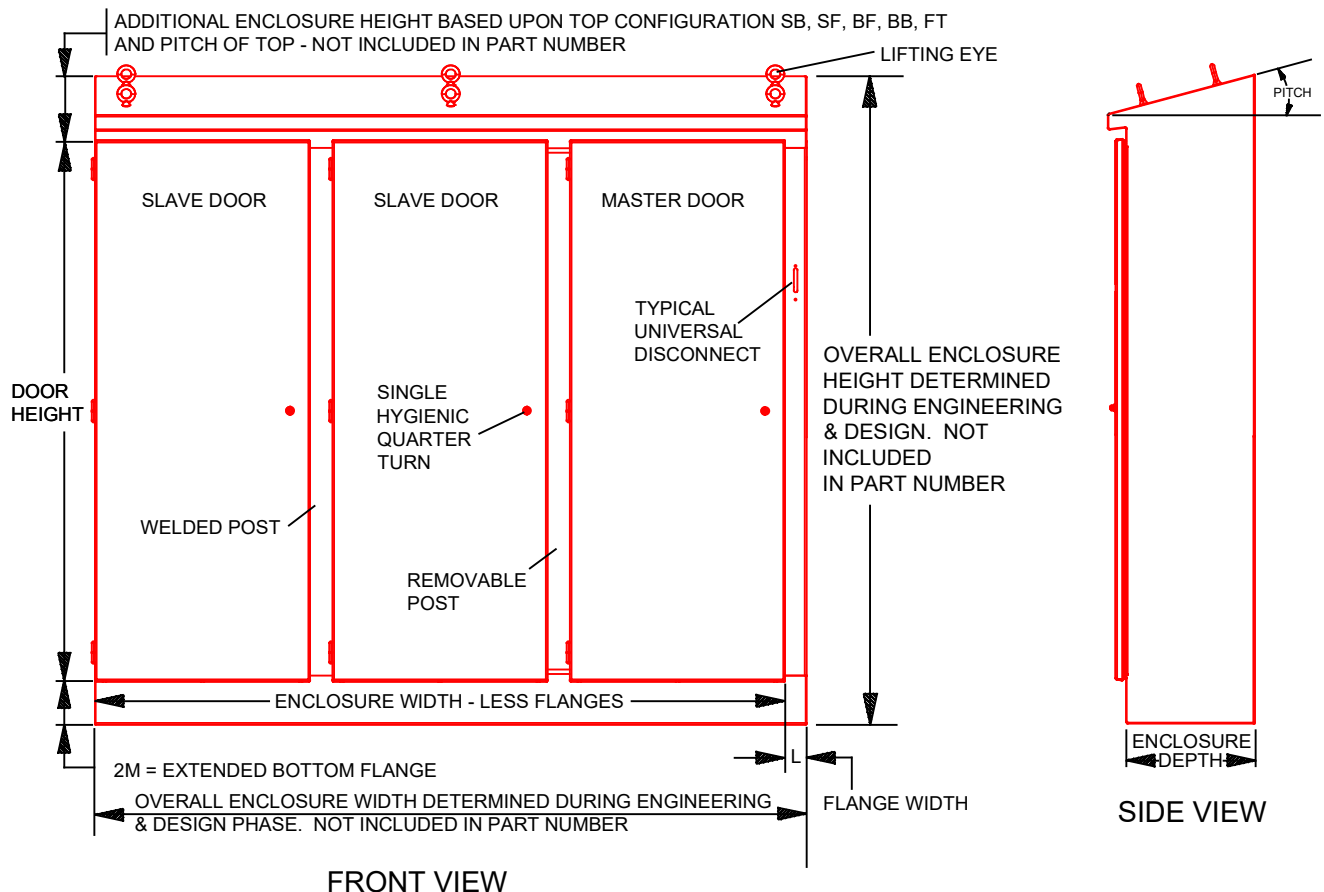

PART# SYSTEM - SINGLE DOOR FLANGED ENCLOSURES WITH SEQUESTER

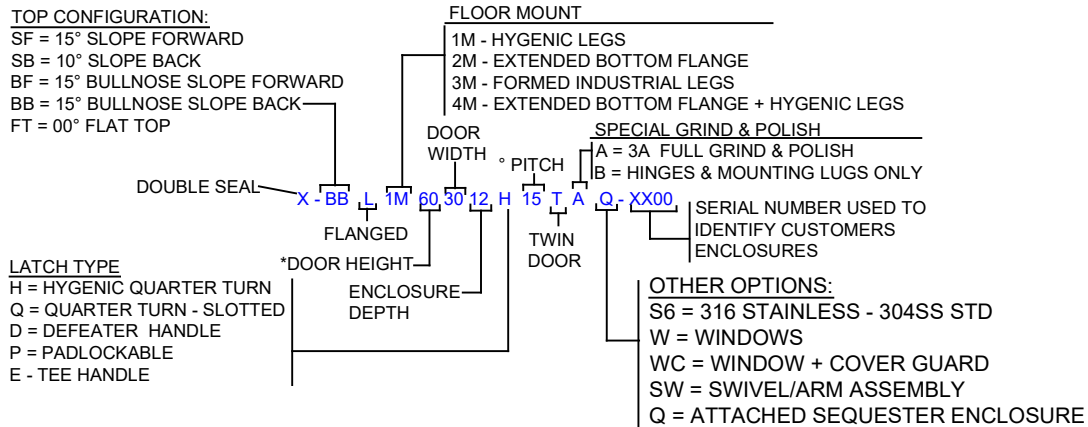

** BACK PANEL PART # SYSTEM

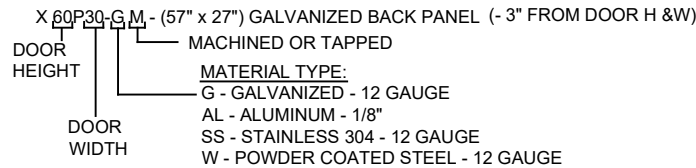

NOTE: * ACTUAL DOOR HEIGHT IS 1/2" TALLER THAN PART# SIZE
 ** BACK PANEL PART NUMBER IS BASED UPON DOOR SIZE

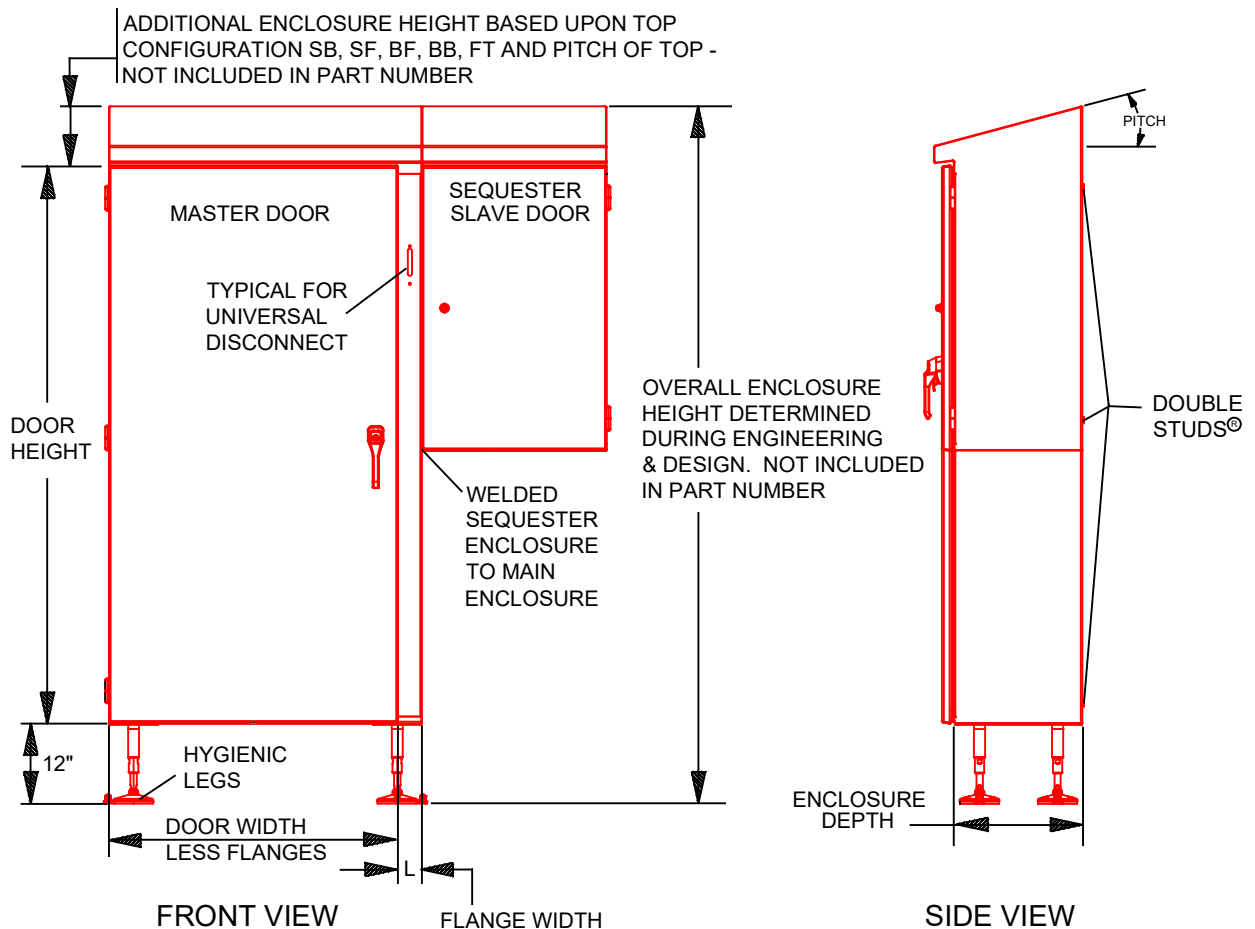

PART# SYSTEM - MULTI DOOR FLANGED ENCLOSURES WITH SEQUESTER

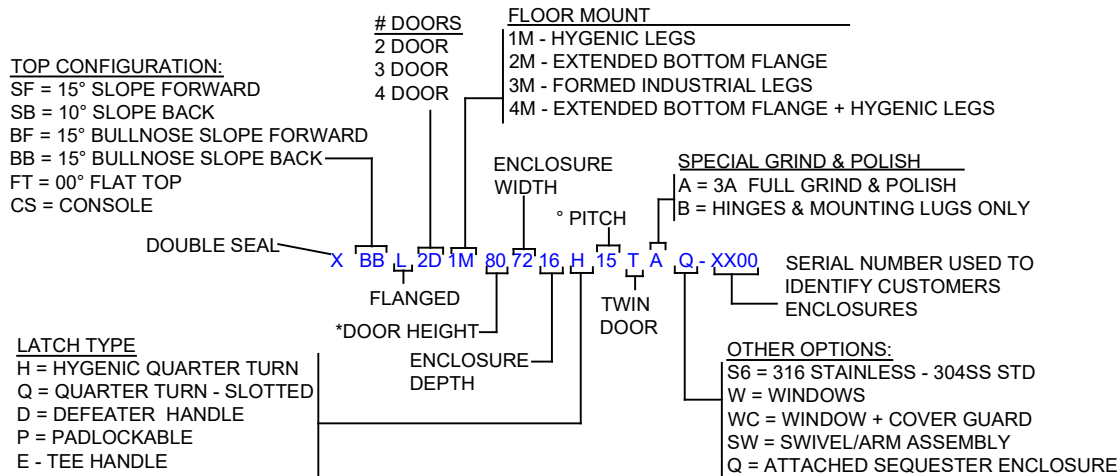

MULTI DOOR - BACK PANEL PART # SYSTEM

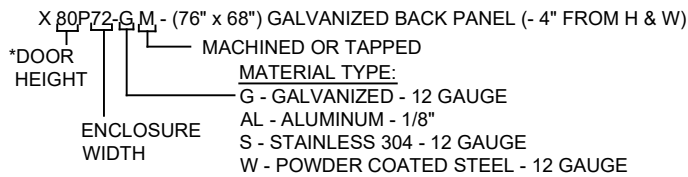

NOTE: * BACK PANEL PART NUMBER IS TYPICALLY BASED UPON ENCLOSURE SIZE

